



VESTIL MANUFACTURING CORP.
 2999 North Wayne Street, P.O. Box 507, Angola, IN 46703
 Telephone: (260) 665-7586 -or- Toll Free (800) 348-0868
 Fax: (260) 665-1339
 www.vestilmfg.com e-mail: sales@vestil.com

FORK-J Fork Truck Jack System Instruction Manual



Receiving instructions:

After delivery, IMMEDIATELY remove the packaging from the product in a manner that preserves the packaging. Inspect the product closely to determine whether it sustained damage during transport. **If damage is discovered, immediately record a complete description of the damage on the bill of lading.** If the product is undamaged, discard the packaging.

NOTICES:

- 1) Compliance with laws, regulations, codes, and non-voluntary standards enforced in the location where the product is *used* is exclusively the responsibility of the owner/end-user.
- 2) VESTIL is **not liable** for any injury or property damage that occurs as a consequence of failing to apply either:
 - a) Instructions in this manual; or
 - b) Information provided on labels affixed to the product.

Vestil is not responsible for consequential damages sustained while assembling, using, or maintaining this product.

Table of Contents

Signal Words.....	2
Safe use recommendations.....	2
Operation.....	2
Exploded parts diagram & bill of materials.....	3
Specifications.....	3
Limited warranty.....	4

Signal Words:

This manual uses SIGNAL WORDS to indicate the likelihood of personal injuries, as well as the probable seriousness of those injuries, if the product is misused in the ways described. Other signal words call attention to uses of the product likely cause property damage. The signal words used in this manual appear below along with the meaning of each word:



Identifies a hazardous situation which, if not avoided, **WILL** result in **DEATH** or **SERIOUS INJURY**. Use of this signal word is limited to the most extreme situations.



Identifies a hazardous situation which, if not avoided, **COULD** result in **DEATH** or **SERIOUS INJURY**.



Indicates a hazardous situation which, if not avoided, **COULD** result in **MINOR** or **MODERATE** injury.



Identifies practices likely to result in product/property damage, such as operation that might damage the product or other property.

Safe use recommendations:



Improper or careless use of this product might result in serious personal injuries or death.

- DO NOT exceed to rated capacity of the jack (8,800 lb. 4000kg).
- DO NOT attempt to lift a fork truck completely off of the ground with this jack system. At least 2 wheels must maintain contact with the ground.
- DO NOT use more than one jack to lift a fork truck.
- DO NOT slide the jack under a truck beyond the red line that appears on the "NOTICE" decal. The decal is applied to the top surface of "Lifting frame" (see item 58 in Bill of Materials on p. 3).
- DO NOT use any cribbing in conjunction with the jack or the jack stands. For instance, never put blocks underneath the jack or on top of it in order to increase the maximum jack height.
- Keep hands, feet, clothing, etc. away from the moving scissor mechanism at all times.
- DO NOT drive the fork truck off of the jack. Lower the jack until all wheels firmly contact the ground and remove the jack and jack stands before driving the truck.
- DO NOT work on the fork truck if it is only supported by the jack. Always support the truck with the jack stands before beginning work. To support a truck with the stands:
 1. Elevate the truck with the jack.
 2. Position the jack stands beneath the frame of the truck on the same side as the jack. The stands should be located at the front and rear of the frame.
 3. Lower the jack until the frame rests solidly on both jack stands.
- DO NOT modify the jack or the stands without first receiving written approval from the manufacturer. Unapproved modifications automatically void the limited warranty and might make the jack and/or the stands unsafe to use.

Operation:

To operate the jack, simply grasp the handle and slide the front end of the jack under the fork truck. A label on the top surface of the lifting frame displays a red line. Do not slide the jack further beneath the truck than the red line. Turn the knob at the top of the pump body to the fully closed position (clockwise). Then, move the handle up-and-down to raise the lifting frame. Fine tune the position of the jack, if necessary, to bring the lifting frame into solid contact with the frame of the fork truck. Position a jack stand at the front and rear of the truck frame on the side of the truck being raised. Continue to raise the jack until jack stands can be placed underneath the front and rear ends of the truck frame. Slowly lower the truck frame onto the jack stands by slowly turning the knob towards the "Open" position (counterclockwise). NOTE: The more the knob is rotated counterclockwise, the faster the jack lowers.

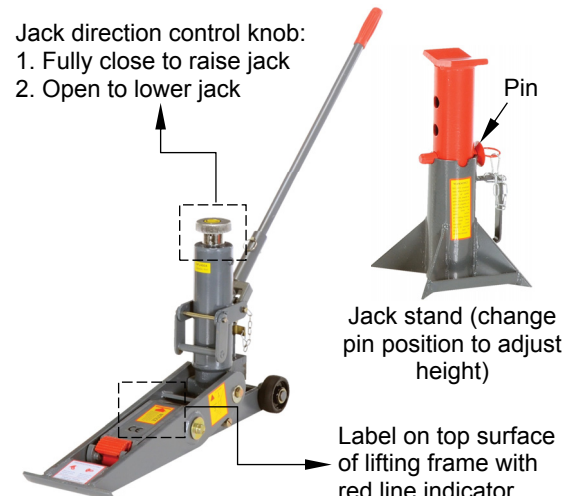

Exploded parts diagram and bill of materials

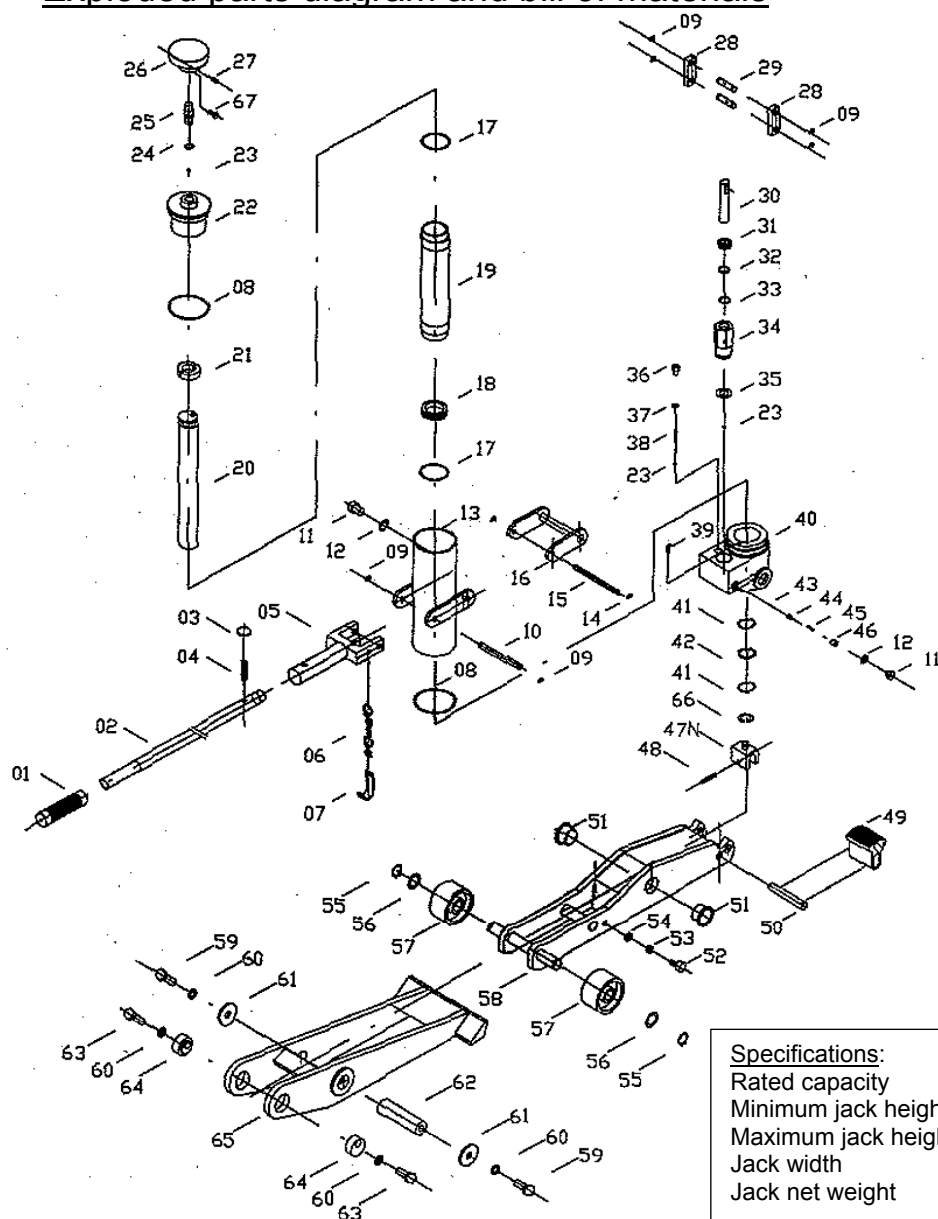

Item no.	Description	Quantity	Item no.	Description	Quantity	Item no.	Description	Quantity
1	Grip	1	23	Ball	3	45	Spring	1
2	Handle	1	24	O-ring	1	46	Screw	1
3	Ring	1	25	Release rod	1	47	Piston rod pad	1
4	Pin	1	26	Release knob	1	48	Pin	1
5	Handle base	1	27	Screw	1	49	Saddle	1
6	Chain	1	28	Link rod	2	50	Pin	1
7	Chain hook	1	29	Pin	2	51	Spacer	2
8	O-ring	2	30	Plunger	1	52	Screw	2
9	Retaining ring	6	31	Wiper	1	53	Lock washer	2
10	Pin	1	32	Backup ring	1	54	Nut	2
11	Screw	2	33	O-ring	1	55	Snap ring	2
12	Seal ring	2	34	Pump	1	56	Washer	2
13	Oil tank	1	35	Seal ring	1	57	Wheel	2
14	Retaining ring	2	36	Screw	1	58	Lifting frame	1
15	Pin	1	37	Seal ring	1	59	Screw	2
16	Handle	1	38	Spring	1	60	Lock washer	4
17	O-ring	2	39	Magnet	1	61	Washer	2
18	Port ring	1	40	Valve block	1	62	Axle	1
19	Cylinder	1	41	O-ring	2	63	Screw	2
20	Piston rod	1	42	Backup ring	1	64	Trunnion	2
21	Piston	1	43	Ball	1	65	Frame 1	1
22	Valve seat	1	44	Ball seat	1	66	Snap ring	1
						67	Screw	1

LIMITED WARRANTY

Vestil Manufacturing Corporation ("Vestil") warrants this product to be free of defects in material and workmanship during the warranty period. *Our warranty obligation is to provide a replacement for a defective original part if the part is covered by the warranty, after we receive a proper request from the warrantee (you) for warranty service.*

Who may request service?

Only a warrantee may request service. *You are a warrantee if* you purchased the product from Vestil or from an authorized distributor AND Vestil has been fully paid.

What is an "original part"?

An original part is a part used to make the product as shipped to the warrantee.

What is a "proper request"?

A request for warranty service is proper if Vestil receives: 1) a photocopy of the Customer Invoice that displays the shipping date; AND 2) a written request for warranty service including your name and phone number. Send requests by any of the following methods:

Mail
Vestil Manufacturing Corporation
2999 North Wayne Street, PO Box 507
Angola, IN 46703

Fax
(260) 665-1339
Phone
(260) 665-7586

Email
sales@vestil.com

In the written request, list the parts believed to be defective and include the address where replacements should be delivered.

What is covered under the warranty?

After Vestil receives your request for warranty service, an authorized representative will contact you to determine whether your claim is covered by the warranty. Before providing warranty service, Vestil may require you to send the entire product, or just the defective part or parts, to its facility in Angola, IN. The warranty covers defects in the following original/ dynamic components: motors, hydraulic pumps, electronic controllers, switches and cylinders. It also covers defects in original parts that wear under normal usage conditions ("wearing parts"), such as bearings, hoses, wheels, seals, brushes, and batteries.

How long is the warranty period?

The warranty period for original dynamic components is 30 days. For wearing parts, the warranty period is 30 days. The warranty periods begin on the date when Vestil ships the product to the warrantee. If the product was purchased from an authorized distributor, the periods begin when the distributor ships the product. Vestil may, at its sole discretion, extend the warranty periods for products shipped from authorized distributors by up to 30 days to account for shipping time.

If a defective part is covered by the warranty, what will Vestil do to correct the problem?

Vestil will provide an appropriate replacement for any covered part. An authorized representative of Vestil will contact you to discuss your claim.

What is not covered by the warranty?

1. Labor;
2. Freight;
3. Occurrence of any of the following, which automatically voids the warranty:
 - Product misuse;
 - Negligent operation or repair;
 - Corrosion or use in corrosive conditions;
 - Inadequate or improper maintenance;
 - Damage sustained during shipping;
 - Accidents involving the product;
 - Unauthorized modifications: DO NOT modify the product IN ANY WAY without first receiving written authorization from Vestil. Modification(s) might make the product unsafe to use or might cause excessive and/or abnormal wear.

Do any other warranties apply to the product?

Vestil Manufacturing Corp. makes no other express warranties. All implied warranties are disclaimed to the extent allowed by law. Any implied warranty not disclaimed is limited in scope to the terms of this Limited Warranty.

