



Bluetooth® Lock Boxes

- Includes Master Lock Vault Enterprise IOS and Android app, and web interface, designed for business applications working with many locks and many users
- Use your smartphone to open and manage your lock with the Master Lock Vault Enterprise app
- No keys to lose, no combinations to forget. No unauthorized key duplication
- Backup access using numeric code on lock keypad
- Share access with others - temporary or permanent
- Easily monitor access with robust data and audit trails
- Model **SGL138** has removable shackle for easy portability and installation
- Model **SGL139** includes mounting hardware for easy installation
- Low battery notification & reminder on device and in app
- Comes with easy to replace CR123A battery
- Large storage capacity for keys and access cards
- Body Material: Hardened Steel
- Shackle Material: Boron Steel
- Colour: Black/Silver
- Key Type: No Key



SGL138



Model No.	Mfg. No.	Description	Body Width"	Shackle Diameter"	Shackle Clearance Height"	Shackle Clearance Width"	Price /Each
SGL138	5440ENT	Portable	3-1/4	13/32	1-13/32	1-13/16	
SGL139	5441ENT	Wall-Mount	3-1/4	-	-	-	

Master Lock High Security Hasps

- Ideal for vans, trucks, gates and vending machines
- Hardened steel hasp withstands forcible attacks
- Defeats attempts to pry and cut
- Designed to be used with **SGC384** (hidden shackle lock) for maximum security

SAO687

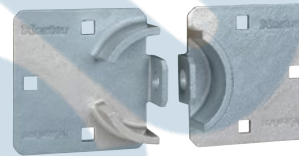

Model No.	Mfg. No.	Description	Hasp Length Inches	mm	Max Shackle Dia. Inches	mm	Shipping Weight (lbs.)	Price /Each
SAO687	770	9" x 4 1/2"	9	228	Accepts only puck locks		3.00	
SGC384	A2010	Lock	-	-	-	-	-	



Master Lock Heavy-Duty Security Hasps

- Zinc-plated hardened steel for added strength and weatherability
- Hardened steel staple resists cutting, sawing and hammering
- Hasp body conceals mounting hardware
- Mounting hardware included for easy installation
- Combine model **SEJ522** with **SGC384** (hidden shackle lock) for maximum security

SEJ522



Model No.	Mfg. No.	Description	Hasp Length Inches	mm	Max Shackle Dia. Inches	mm	Shipping Weight (lbs.)	Price /Each
SEJ522	730	7 1/4" Straight Bar	7 1/4	180	7/16	11	1.25	
SGC384	A2010	Lock	-	-	-	-	-	



Master Lock Hinged Security Hasps

- Secure hard-to-lock property, ideal for corners and angles
- Hardened steel body for added strength
- Hardened boron alloy staples resist cutting and sawing
- Single and double hinge styles with hidden hinge pins



SEJ523



SEJ524

Model No.	Mfg. No.	Description	Hasp Length Inches	mm	Max Shackle Dia. Inches	mm	Shipping Weight (lbs.)	Price /Each
SEJ523	722DPF	Double Hinge	7 3/4	197	7/16	11	0.94	
SEJ524	720DPF	Single Hinge	6 1/4	159	7/16	11	0.80	



Master Lock General Security Hardened Steel Hasps

- Hardened steel locking eyes for strong cut resistance
- Hardened steel staples resist cutting and sawing
- Tamper proof hinges help resist prying
- Zinc plated hardened steel for added strength and weatherability



Model No.	Mfg. No.	Description	Hasp Length Inches	mm	Max Shackle Dia. Inches	mm	Shipping Weight (lbs.)	Price /Each
SEJ525	706D	Hard Wrought Steel Body	6	152	9/16	14	0.60	
SEJ526	704DPF	Hard Wrought Steel Body	4 1/2	114	1/2	13	0.40	
SAG267	703D	Hard Wrought Steel Body	3 1/2	89	11/32	9	0.30	
SEJ527	702D	Hard Wrought Steel Body	2 1/2	64	9/32	7	0.20	

