



VESTIL MANUFACTURING CORP.

2999 North Wayne Street, P.O. Box 507, Angola, IN 46703
 Telephone: (260) 665-7586 -or- Toll Free (800) 348-0868
 Fax: (260) 665-1339

www.vestilmfg.com e-mail: sales@vestil.com

LP-4000 SERIES THIN SPINS
INSTRUCTION MANUAL



Receiving instructions:

After delivery, IMMEDIATELY remove the packaging from the product in a manner that preserves the packaging and maintains the orientation of the product in the packaging; then inspect the product closely to determine whether it sustained damage during transport. **If damage is discovered during the inspection, immediately record a complete description of the damage on the bill of lading.** If the product is undamaged, discard the packaging.

NOTES:

- 1) Compliance with laws, regulations, codes, and non-voluntary standards enforced in the location where the product is *used* is exclusively the responsibility of the owner/end-user.
- 2) VESTIL is **not liable** for any injury or property damage that occurs as a consequence of failing to apply either: a) the instructions in this manual; or b) information provided on labels affixed to the product. Neither is Vestil responsible for *any* consequential damages sustained as a result of failing to exercise sound judgment while assembling, installing, using or maintaining this product.

Table of Contents

Hazard identification: explanation of signal words.....	2
Safety Guidelines.....	2
Exploded parts diagram and bills of materials.....	3
Use instructions.....	4
Inspections & maintenance.....	4-5
Label placement diagram	5
Limited warranty.....	6

HAZARD IDENTIFICATION: explanation of signal words

This manual uses SIGNAL WORDS to indicate the likelihood of personal injuries, as well as the probable seriousness of those injuries, if the product is misused in the ways described. Other signal words call attention to uses of the product likely cause property damage.

The signal words used appear below along with the meaning of each word:



Identifies a hazardous situation which, if not avoided, **WILL** result in **DEATH** or **SERIOUS INJURY**. Use of this signal word is limited to the most extreme situations.



Identifies a hazardous situation which, if not avoided, **COULD** result in **DEATH** or **SERIOUS INJURY**.



Indicates a hazardous situation which, if not avoided, **COULD** result in **MINOR** or **MODERATE** injury.



Identifies practices likely to result in product/property damage, such as operation that might damage the product.

Each person who assembles, installs, uses, or maintains this product should read the entire manual **and fully understand the directions in advance**. **If after reading the manual you do not understand an instruction, ask your supervisor or employer for clarification, because failure to adhere to the directions in this manual might result in serious personal injury.**

SAFETY GUIDELINES

Vestil diligently strives to identify foreseeable hazards associated with the use of its products. However, material handling is inherently dangerous and no manual can address every conceivable risk. The end-user ultimately is responsible for exercising sound judgment at all times.



Failure to read and understand the entire manual before assembling, installing, using and servicing the product *is a misuse of the product.* If this product is used improperly or carelessly, the operator and/or bystanders might sustain serious personal injuries. To reduce the likelihood of injury:

- DO NOT modify the product in any way UNLESS you first obtain written approval from Vestil. Unauthorized modifications automatically void the Limited Warranty and might make the product unsafe to use.
- Read the manual to refresh your understanding of proper use and maintenance procedures.
- DO NOT exceed the maximum rated load (see Label 287 in “Label placement diagram” on p. 18).
- DO NOT stand or sit on the turntable or on the load at any time.
- Loads must not extend over the shelves of the cart.
- Install the machine ONLY on even, level surfaces where the machine will not be exposed to the outdoor environment.
- Keep hand, clothing, etc. out of contact with all moving parts of the machine.
- BEFORE using the wrapping machine, instruct all bystanders to stand away from the machine and the item to be wrapped.
- The person operating the turntable should stand where the mast is between him and the turntable.
- DO NOT activate the turntable UNLESS the load is centered on it and stable. Be prepared to stop the turntable, because rotation can cause the load to shift and become unstable. Because an unstable load might topple during the wrapping process, EVERY person involved should remain far enough away from the machine to avoid contact with the load if it falls. Higher rotation speeds can cause an unstable load to be flung from the turntable.
- DO NOT continue to use the machine if you observe abnormal motion or noise. Immediately tag the unit “Out of service” and report the problem to maintenance personnel.
- DO NOT attempt to resolve any problem(s) with the product unless you are both authorized to do so and *certain* that it will be safe to use afterwards.
- Inspect the product before each use (see “Inspections and Maintenance” on p. 6).
- DO NOT use this device UNLESS all product labels (see “Label Placement Diagram”) are readable and undamaged.



Proper use and maintenance are essential for this product to function properly.

- Always use this product in accordance with the instructions in this manual and consistent with any training relevant to machines, devices, etc. used in conjunction with this product.
- Keep the product clean & dry.

Exploded Parts Diagram and Bill of Materials

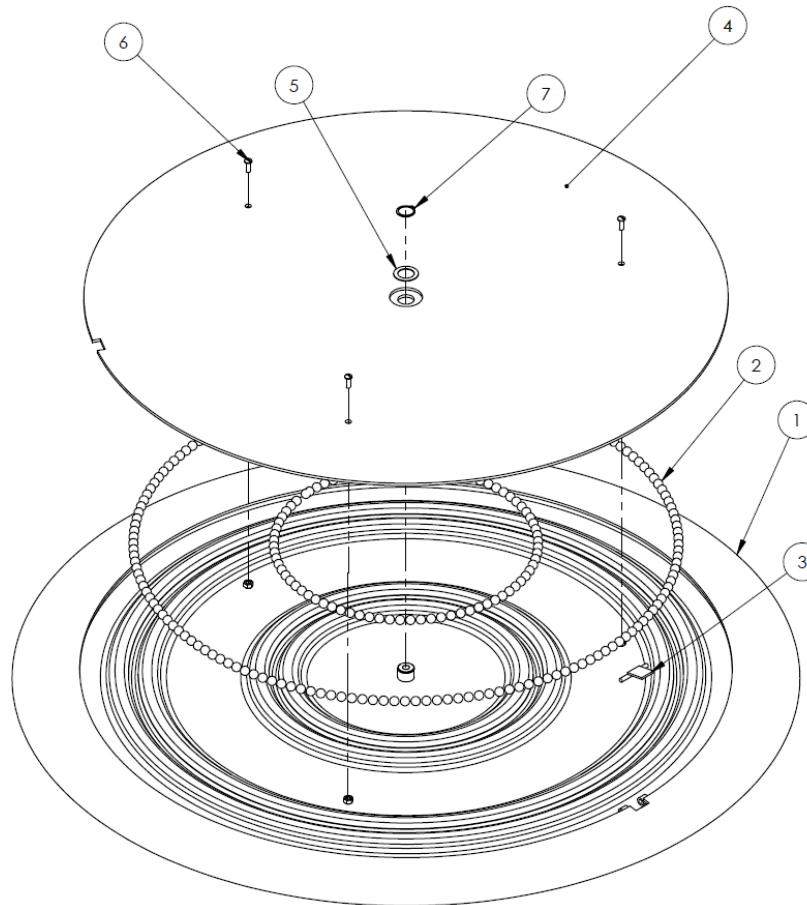

LP-4000T

Item no.	Part no.	Description	Quantity
1	20-513-003	Deck, turntable base, subassembly	1
2	20-110-004	⁹ / ₁₆ in. grade 200 chromed steel ball	300
3	20-537-008	Lock bar assembly	1
4	20-513-002	Deck, tabletop, subassembly	1
5	33444	1in. x 18 gauge machine bushing	1
6	27673	¹ / ₄ in. – 20 x ³ / ₄ in. slotted machine screw	3
7	68019	1in. diameter external retaining ring	1

LP-4000T-39

Item no.	Part no.	Description	Quantity
1	20-513-035	Deck, turntable base, subassembly	1
2	20-110-004	⁹ / ₁₆ in. grade 200 chromed steel ball	240
3	20-537-008	Lock bar assembly	1
4	20-513-033	Deck, tabletop, subassembly	1
5	33444	1in. x 18 gauge machine bushing	1
6	27673	¹ / ₄ in. – 20 x ³ / ₄ in. slotted machine screw	3
7	68019	1in. diameter external retaining ring	1

LP-4000T-45

Item no.	Part no.	Description	Quantity
1	20-513-036	Deck, turntable base, subassembly	1
2	20-110-004	⁹ / ₁₆ in. grade 200 chromed steel ball	300
3	20-537-008	Lock bar assembly	1
4	20-513-034	Deck, tabletop, subassembly	1
5	33444	1in. x 18 gauge machine bushing	1
6	27673	¹ / ₄ in. – 20 x ³ / ₄ in. slotted machine screw	3
7	68019	1in. diameter external retaining ring	1

Use Instructions

To prevent the tabletop and base from separating during shipping, the top is fastened to the bottom with screws. Before using the turntable for the first time, remove the three slotted machine screws, which are shown in the exploded parts diagrams on p. 3.

To use the turntable, simply place a load on the tabletop.

NOTICE DO NOT exceed the load rating OR drop loads onto the turntable, because excessive loads and shock loading will cause the bearings to fail prematurely.

To protect the load bearings, be careful when loading the turntable and **slowly** apply loads to the turntable. In particular, take care to not drop items on the table or to slam the tines of your fork lift on it.

The turntable incorporates a lock bar assembly to immobilize the tabletop. The tabletop should be locked whenever it is not in use. To lock the tabletop, align the notch in the tabletop with the lock bar and flip the lock bar into the notch.

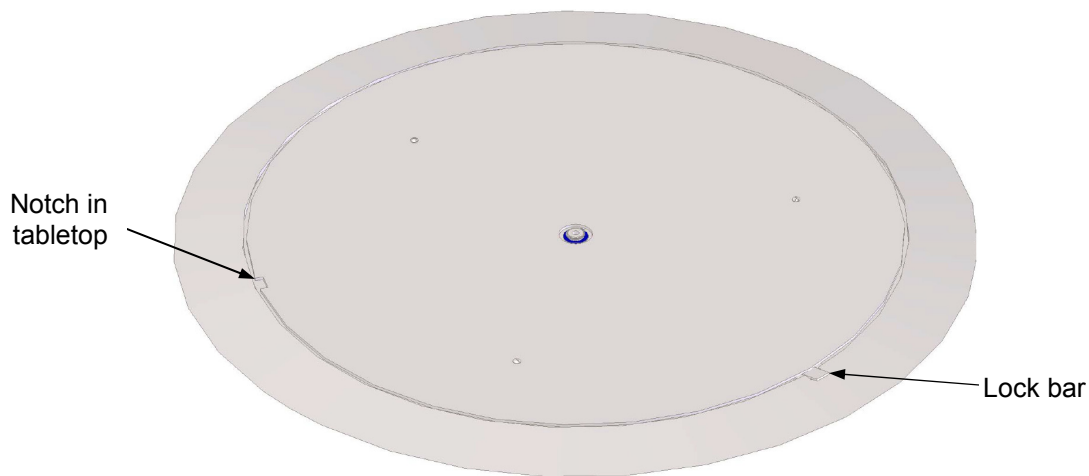

Inspections & Maintenance

Before each use, inspect the listed components:

1. Turntable top and base: check each structure for bends, warps and cracks.
2. Operate the turntable: rotate the table top; observe and listen for unusual noise or movement, or binding.
3. Product labels: all labels should be readable and located as shown in the "Label placement diagram" on p. 5. If a label(s) is unreadable or missing, order a replacement.

NOTE: Label appearance and content is subject to change, and consequently, replacement labels might differ from labels shown in the manual supplied with the unit.

At least once per month, inspect the turntable and all optional equipment, e.g. ramp, for damage that affects normal operation. In particular, inspect:

1. Fasteners (hardware): check fasteners for looseness and damage. Tighten all loose fasteners (bolts, nuts, washers); replace any that are damaged;
2. Turntable top: examine the turntable top for significant wear and impact damage. Sharp projections might develop along the edge of the turntable. Sand or grind off all projections, burrs, etc.
3. Load bearings: remove the 1in. external retaining ring (see exploded parts diagram, p. 3), then lift the table top and set it aside.
 - a. Inspect the ball bearings. Replace all bearing that are significantly worn.
 - b. Examine the tracks of the turntable base (see exploded parts diagrams, p. 3) that guide the bearings. Remove dirt and all other debris from the tracks.

- c. Examine the underside of the tabletop
- d. Reassemble the turntable. Rotate the tabletop and listen for scraping sounds. If the turntable is noisy while it rotates, replace the load bearings.
- 4. Lock bar assembly: verify that the lock bar assembly (see exploded parts diagrams on p. 3) is in place and functions properly.
- 5. Labels: confirm that all labels (shown in “Label placement diagram” on p. 5) are present, undamaged and readable.
- 6. Overall condition of turntable: the structure should be clean, square and rigid, and free of rust and corrosion. Remove dirt and debris from all surfaces. Do not use the thin spin if the base is excessively rusted or corroded.

Label Placement Diagram

The turntable should be labeled as shown below. Replace all labels that are damaged or unreadable.



MODEL/MODELO/MODELE	_____
STATIC CAPACITY (evenly distributed)	_____ lbs.
LA CAPACIDAD CONSTANTE (distribuida uniformemente)	_____ kgs.
CAPACITÉ STATIQUE (distribuée régulièrement)	_____ kgs.
SERIAL/SERIE/SÉRIE	_____
VESTIL MANUFACTURING CORPORATION	
Phone (260) 695-7585 • sales@vestil.com • www.vestil.com	

287

(Cover with label 770)



335

LIMITED WARRANTY

Vestil Manufacturing Corporation (“Vestil”) warrants this product to be free of defects in material and workmanship during the warranty period. *Our warranty obligation is to provide a replacement for a defective original part if the part is covered by the warranty, after we receive a proper request from the warrantee (you) for warranty service.*

Who may request service?

Only a warrantee may request service. *You are a warrantee if* you purchased the product from Vestil or from an authorized distributor AND Vestil has been fully paid.

What is an “original part”?

An original part is a part used to make the product as shipped to the warrantee.

What is a “proper request”?

A request for warranty service is proper if Vestil receives: 1) a photocopy of the Customer Invoice that displays the shipping date; AND 2) a written request for warranty service including your name and phone number. Send requests by any of the following methods:

Mail
Vestil Manufacturing Corporation
2999 North Wayne Street, PO Box 507
Angola, IN 46703

Fax
(260) 665-1339
Phone
(260) 665-7586

Email
sales@vestil.com

In the written request, list the parts believed to be defective and include the address where replacements should be delivered.

What is covered under the warranty?

After Vestil receives your request for warranty service, an authorized representative will contact you to determine whether your claim is covered by the warranty. Before providing warranty service, Vestil may require you to send the entire product, or just the defective part or parts, to its facility in Angola, IN. The warranty covers defects in the following *original* dynamic components: motors, hydraulic pumps, electronic controllers, switches and cylinders. It also covers defects in *original* parts that wear under normal usage conditions (“wearing parts”): bearings, hoses, wheels, seals, brushes, batteries, and the battery charger.

How long is the warranty period?

The warranty period for original components is 90 days. The warranty period begins on the date when Vestil ships the product to the warrantee. If the product was purchased from an authorized distributor, the period begins when the distributor ships the product. Vestil may extend the warranty period for products shipped from authorized distributors by *up to* 30 days to account for shipping time.

If a defective part is covered by the warranty, what will Vestil do to correct the problem?

Vestil will provide an appropriate replacement for any *covered* part. An authorized representative of Vestil will contact you to discuss your claim.

What is not covered by the warranty?

1. Labor;
2. Freight;
3. Occurrence of any of the following, which automatically voids the warranty:
 - Product misuse;
 - Negligent operation or repair;
 - Corrosion or use in corrosive environments;
 - Inadequate or improper maintenance;
 - Damage sustained during shipping;
 - Collisions or other incidental contacts causing damage to the product;
 - Unauthorized modifications: DO NOT modify the product IN ANY WAY without first receiving written authorization from Vestil. Modification(s) might make the product unsafe to use or might cause excessive and/or abnormal wear.

Do any other warranties apply to the product?

Vestil Manufacturing Corp. makes no other express warranties. All implied warranties are disclaimed to the extent allowed by law. Any implied warranty not disclaimed is limited in scope to the terms of this Limited Warranty.

